

## Equal Tees, PTFE-Lined

- CS = Carbon Steel
- DI = Ductile Iron
- FAB = Fabricated Steel
- ATL = Advanced Technology Liner

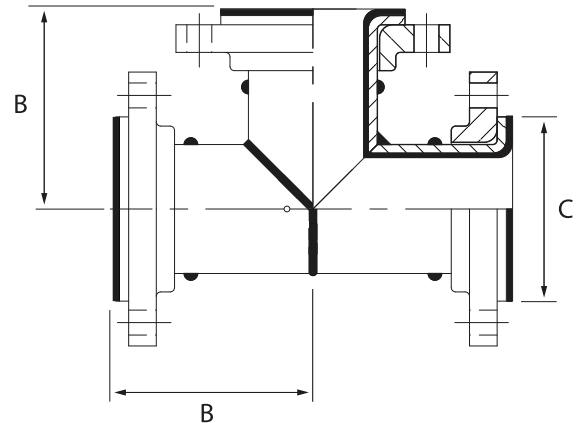

ASME B16.5 Class 150 Flanged										
Size (NPS)	Size (DN)	Dimensions				Available Construction			Weight	
		B		C		FAB with DI Rotating Flanges	FAB with CS Flanges (Fixed or Rotating)	ATL		
		Inch	mm	Inch	mm				lbs.	kg
1/2*	15	3 1/2	89	1 3/4	35		•		5.5	2.5
3/4*	20	3 1/2	89	1 11/16	43		•		7	3.2
1	25	3 1/2	89	2	51	•	•	•	10	4.5
1 1/2	40	4	102	2 7/8	73	•	•	•	14	6.4
2	50	4 1/2	114	3 5/8	92	•	•	•	19.5	8.9
3	80	5 1/2	140	5	127	•	•	•	40	18.2
4	100	6 1/2	165	6 3/16	157	•	•	•	67	30.5
6	150	8	203	8 1/2	216	•	•	•	120	54.5
8	200	9	229	10 5/8	270	•	•	•	180	81.8
10	250	11	279	12 3/4	324	•	•	•	219	99.5
12	300	12	305	15	381	•	•	•	318	144.5
14**	350	14	356	16 1/4	412		•		686	312
16**	400	15	381	18 1/2	470		•		825	375
18**	450	16 1/2	419	21	534		•		880	400
20**	500	18	457	23	585		•		924	420
24**	600	22	559	27 1/4	692		•		1276	580

\* PFA-lined

\*\*Multi-Piece Construction - See Page 18

Vacuum Rating: 1" - 12" is Full Vacuum Rated to 450 F (232 C)

14" - 24" = Consult Factory

Also available in stainless steel

Weights are approximate

Note: Tees are available with shortened branch or run dimensions. Please consult factory with custom requirements.

## Equal Tees, PTFE-Lined

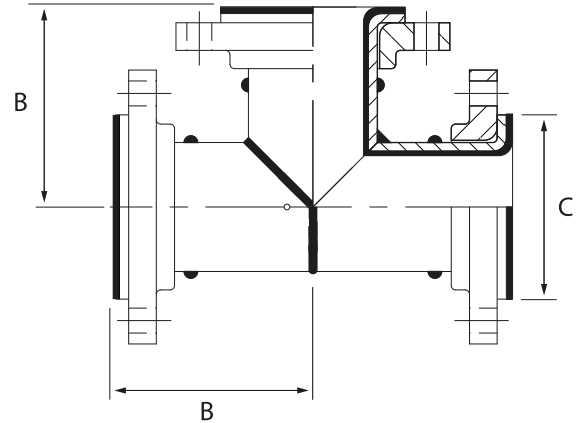

CS = Carbon Steel  
 FAB = Fabricated Steel  
 ATL = Advanced Technology Liner

### ASME B16.5 Class 300 Flanged

Size (NPS)	Size (DN)	Dimensions				Available Construction		Weight	
		B		C		FAB with CS Flanges (Fixed or Rotating)	ATL	lbs.	kg
		Inch	mm	Inch	mm				
1/2	15	3 1/2	89	1 3/4	35	•		5	2
3/4	20	3 1/2	89	1 11/16	43	•		8	4
1	25	4	102	2	51	•	•	8	4
1 1/2	40	4 1/2	114	2 7/8	73	•	•	14	6
2	50	5	127	3 5/8	92	•	•	18	8
3	80	6	152	5	127	•	•	35	16
4	100	7	178	6 3/16	157	•	•	62	28
6	150	8 1/2	216	8 1/2	216	•	•	115	52
8	200	10	254	10 5/8	270	•	•	187	85

Note: 1" - 6" sizes can be made to Class 150 center-face dimensions

Vacuum Rating: Tees are Full Vacuum Rated to 450 F (232 C)

Consult factory for Class 300 flanged fittings in 10" and larger sizes

Also available in stainless steel

Weights are approximate

## Reducing Tees, PTFE-Lined

CS = Carbon Steel  
 DI = Ductile Iron  
 FAB = Fabricated Steel  
 ATL = Advanced Technology Liner

Vacuum Rating: 1" - 12" is Full Vacuum Rated to 450 F (232 C)

Also available in stainless steel

Weights are approximate

\* PFA-Lined

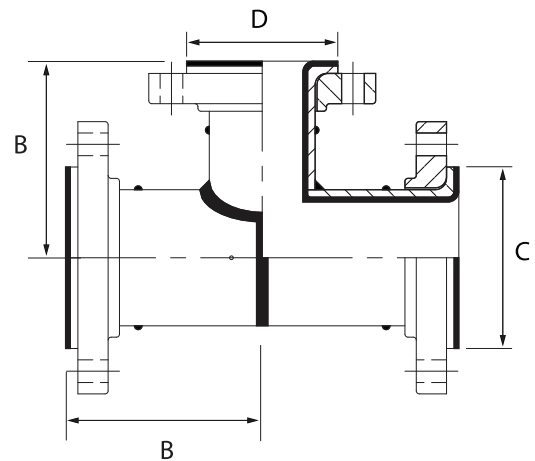

ASME B16.5 Class 150 Flanged												
Major Size NPS (DN)	Minor Size NPS (DN)	Dimensions						Available Construction			Weight	
		B		C		D		FAB with DI Rotating Flanges	FAB with CS Flanges (Fixed or Rotating)	ATL		
		Inch	mm	Inch	mm	Inch	mm				lbs.	kg
1 (25)	1/2 (15)*	3 1/2	89	2	51	1 3/4	35		Fixed		8	3.6
	3/4 (20)*					1 11/16	43		Fixed		9	4.1
1 1/2 (40)	1/2 (15)*	4	102	2 7/8	73	1 3/4	35		Fixed		9	4.1
	3/4 (20)*					1 11/16	43		Fixed		10	4.5
	1 (25)					2	51	•	•	•	12.2	5.5
2 (50)	1 (25)	4 1/2	114	3 5/8	92	2	51	•	•	•	16.2	7.4
	1 1/2 (40)					2 7/8	73	•	•	•	17.6	8.0
3 (80)	1 (25)	5 1/2	140	5	127	2	51	•	•	•	31	14.1
	1 1/2 (40)					2 7/8	73	•	•	•	32.2	14.6
	2 (50)					3 5/8	92	•	•	•	34	15.5
4 (100)	1 (25)	6 1/2	165	6 3/16	157	2	51	•	•	•	45.5	20.7
	1 1/2 (40)					2 7/8	73	•	•	•	56.2	25.5
	2 (50)					3 5/8	92	•	•	•	57	25.9
	3 (80)					5	127	•	•	•	57.7	26.2
6 (150)	2 (50)	8	203	8 1/2	216	3 5/8	92	•	•	•	90.8	41.3
	3 (80)					5	127	•	•	•	80	36.4
	4 (100)					6 3/16	157	•	•	•	105.6	48.0
8 (200)	3 (80)	9	229	10 5/8	270	5	127	•	•	•	162	73.6
	4 (100)					6 3/16	157	•	•	•	165.5	75.2
	6 (150)					8 1/2	216	•	•	•	170.3	77.4
10 (250)	6 (150)	11	279	12 3/4	324	8 1/2	216	•	•	•	250	113.6
	8 (200)					10 5/8	270	•	•	•	260	118.2

# Reducing Tees, PTFE-Lined

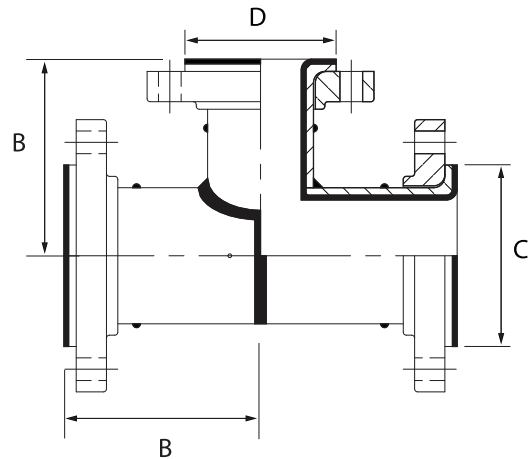

CS = Carbon Steel  
 DI = Ductile Iron  
 FAB = Fabricated Steel  
 ATL = Advanced Technology Liner

14" - 24" reducing tee common branch sizes are shown.  
 Branch sizes down to 1" are available.

ASME B16.5 Class 150 Flanged												
Major Size NPS (DN)	Minor Size NPS (DN)	Dimensions						Available Construction			Weight	
		B		C		D		FAB with DI Rotating Flanges	FAB with CS Flanges (Fixed or Rotating)	ATL	lbs.	kg
		Inch	mm	Inch	mm	Inch	mm					
12 (300)	4 (100)	12	305	15	381	6 3/16	157	•	•	•	260	118.2
	8 (200)					8 1/2	216	•	•	•	270	122.7
	10 (250)					10 5/8	270	•	•	•	280	127.3
	12 (300)					12 3/4	324	•	•	•	290	131.8
14 (350)*	8 (200)	14	356	16 1/4	412	10 5/8	270		•		646.8	294
	12 (300)					12 3/4	324		•		660	300
	14 (350)					15	381		•		677.6	308
16 (400)*	10 (250)	15	381	18 1/2	470	12 3/4	324		•		783.2	356
	12 (300)					15	381		•		796.4	362
	14 (350)					16 1/4	412		•		814	370
18 (450)*	12 (300)	16 1/2	419	21	534	15	381		•		Consult Factory	
	14 (350)					16 1/4	412		•			
	16 (400)					18 1/2	470		•			
20 (500)*	14 (350)	18	457	23	585	16 1/4	412		•			
	16 (400)					18 1/2	470		•			
	18 (450)					21	534		•			
24 (600)*	16 (400)	22	559	27 1/4	692	18 1/2	470		•			
	18 (450)					21	534		•			
	20 (500)					23	585		•			

\* Multi-Piece Construction - See Page 18

Vacuum Rating: 1" - 12" is Full Vacuum Rated to 450 F (232 C)  
 14" - 24" = Consult Factory

Also available in stainless steel  
 Weights are approximate

## Reducing Tees, PTFE-Lined

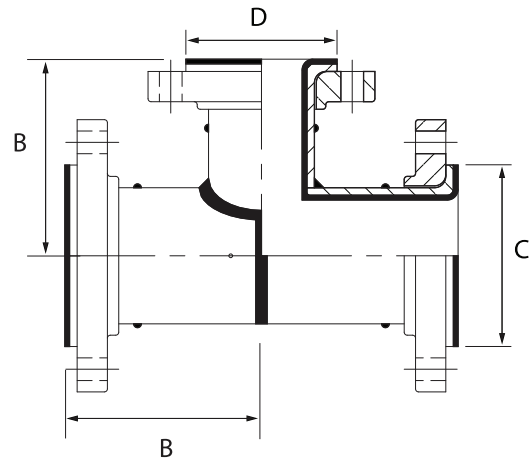

CS = Carbon Steel  
 DI = Ductile Iron  
 FAB = Fabricated Steel  
 ATL = Advanced Technology Liner

ASME B16.5 Class 300 Flanged												
Major Size NPS (DN)	Minor Size NPS (DN)	Dimensions						Available Construction			Weight	
		B		C		D		FAB with DI Rotating Flanges	FAB with CS Flanges (Fixed or Rotating)	ATL		
		Inch	mm	Inch	mm	Inch	mm				lbs.	kg
1.5 (40)	1 (25)	4	102	2 7/8	73	2	51	•	•	•	18.5	8.4
2 (50)	1 (25)	4 1/2	114	3 5/8	92	2	51	•	•	•	21.1	9.6
	2 7/8					73	•	•	•	24.3	11	
3 (150)	1 (25)	5 1/2	140	5	127	2	51	•	•	•	41.3	18.8
	2 7/8					73	•	•	•	44.3	20.1	
	3 5/8					92	•	•	•	45.4	20.6	
4 (100)	1.5 (40)	6 1/2	165	6 3/16	157	2 7/8	73	•	•	•	78.5	35.7
	3 5/8					92	•	•	•	78.6	35.7	
	5					127	•	•	•	82	37.3	
6 (150)	2 (50)	8	203	8 1/2	216	3 5/8	92	•	•	•	128.8	58.5
	5					127	•	•	•	120.7	54.9	
	6 3/16					157	•	•	•	151.4	68.8	
8 (200)	3 (80)	9	229	10 5/8	270	5	127	•	•	•	222.7	101.2
	6 3/16					157	•	•	•	231.3	105.1	
	8 1/2					216	•	•	•	244.3	111	

Vacuum Rating: 1" - 12" is Full Vacuum Rated to 450 F (232 C)  
 14" - 24" = Consult Factory

Also available in stainless steel  
 Weights are approximate

## Fabricated Two-Piece Reducing Tees, PTFE-Lined

CS = Carbon Steel  
 DI = Ductile Iron  
 FAB = Fabricated Steel  
 ATL = Advanced Technology Liner

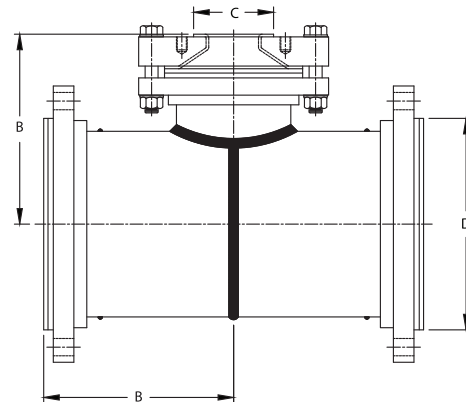

ASME B16.5 Class 150 Flanged										
Major Size NPS (DN)	Minor Size NPS (DN)	Dimensions						Available Construction		
		B		C		D		FAB with DI Rotating Flanges	FAB with CS Flanges (Fixed or Rotating)	ATL
		Inch	mm	Inch	mm	Inch	mm			
6 (150)	1 (25)	8	203	8 1/2	216	2	51	•	•	•
	1.5 (40)					2 7/8	73	•	•	•
8 (200)	1 (25)	9	229	10 5/8	270	2	51	•	•	•
	1.5 (40)					2 7/8	73	•	•	•
	2 (50)					3 5/8	92	•	•	•
10 (250)	1 (25)	11	279	12 3/4	324	2	51	•	•	•
	1.5 (40)					2 7/8	73	•	•	•
	2 (50)					3 5/8	92	•	•	•
	3 (80)					5	127	•	•	•
12 (300)	1 (25)	12	305	15	381	2	51	•	•	•
	1.5 (40)					2 7/8	73	•	•	•
	2 (50)					3 5/8	92	•	•	•
	3 (80)					5	127	•	•	•

Construction is a reducing tee with a shortened stack and a reducing filler flange bolted together

Vacuum Rating = Full at 450 F

Also available in stainless steel

Consult factory for weights