

Blind Flanges, PTFE-Lined

Carbon steel or stainless steel

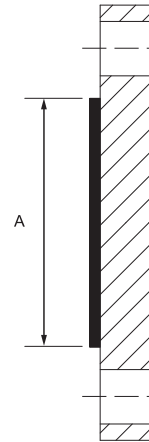

PTFE Liner Thickness = 3/16"

ASME B16.5 Class 150						ASME B16.5 Class 300					
Size (NPS)	Size (DN)	A		Weight		Size (NPS)	Size (DN)	A		Weight	
		Inch	mm	lbs.	kg			Inch	mm	lbs.	kg
1/2	15	1 3/4	35	1.1	0.5	1/2	15	1 3/4	35	1.5	0.7
3/4	20	1 11/16	43	1.2	0.5	3/4	20	1 11/16	43	2.3	1
1	25	2	51	1.9	0.9	1	25	2	51	3	1.4
1 1/2	40	2 7/8	73	3.7	1.7	1 1/2	40	2 7/8	73	6.3	2.9
2	50	3 5/8	92	6	2.7	2	50	3 5/8	92	7.8	3.5
3	80	5	127	9.9	4.5	3	80	5	127	14.1	6.4
4	100	6 3/16	157	16.8	7.6	4	100	6 3/16	157	26.7	12.1
6	150	8 1/2	216	28.5	13	6	150	8 1/2	216	49.6	22.5
8	200	10 5/8	270	47	21.4	8	200	10 5/8	270	79.3	36
10	250	12 3/4	324	67	30.5	10	250	12 3/4	324	121.3	55.1
12	300	15	381	114	51.8	12	300	15	381	192.3	87.4
14	350	16 1/4	413	128.7	58.5	14	350	16 1/4	413	231.9	105.4
16	400	18 1/2	470	169.4	77	16*	400	18 1/2	470	303.4	137.9
18	450	21	533	209	95	18*	450	21	533	387.9	176.3
20*	500	23	584	290.4	132	20*	500	23	584	508.2	231
24*	600	27 1/4	692	429	195	24*	600	27 1/4	692	767.8	349

20" and 24" are made supplied as an unlined blind flange and separate 1/2" thick PTFE blind ring spacer. Other sizes can also be provided with the same blind flange + spacer construction.