

45 Degree Elbows, PTFE-Lined

CS = Carbon Steel
 DI = Ductile Iron
 FAB = Fabricated Steel
 ATL = Advanced Technology Liner

Vacuum Rating: 1" - 12" is Full Vacuum Rated to 450 F (232 C)
 14" - 20" = Consult Factory

Also available in stainless steel

Weights are approximate

* Multi-Piece Construction - See Page 18

** Dimension not according to ASME B16.5 Class 150.

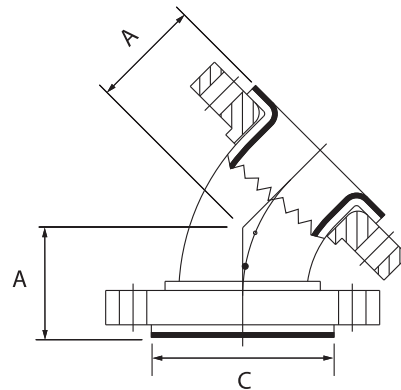

ASME B16.5 Class 150 Flanged												
Size (NPS)	Size (DN)	Dimensions				Available Construction					Weight	
		A		C		FAB with DI Rotating Flanges	FAB with CS Flanges (Fixed or Rotating)	Cast DI A395	Cast Steel A216 WCB	ATL	lbs.	kg
		Inch	mm	Inch	mm							
1/2	15	1 3/4	45	1 3/4	35		•				4.6	2.1
3/4	20	1 3/4	45	1 11/16	43		•				5	2.3
1	25	1 3/4	45	2	51	•	•	•	•	•	5.3	2.4
1 1/2	40	2 1/4	57	2 7/8	73	•	•	•		•	8	3.6
2	50	2 1/2	64	3 5/8	92	•	•		•	•	12.1	5.5
3	80	3	76	5	127	•	•			•	21.5	9.8
4	100	4	102	6 3/16	157	•	•		•	•	39.5	18.0
6	150	5	127	8 1/2	216	•	•	•		•	57.5	26.1
8	200	5 1/2	140	10 5/8	270	•	•	•		•	98.6	44.8
10	250	6 1/2	165	12 3/4	324	•	•	•		•	100	45.5
12	300	7 1/2	190	15	381	•	•	•		•	160	72.7
14	350	7 1/2	191	16 1/4	413		•				275	125
16	400	10**	254	18 1/2	470		•				319	145
18	450	12**	305	21	533		•				407	185
20*	500	13 1/2**	343	23	584		•				462	210
24*	500	15 1/2**	394	27 1/4	692		•				Consult Factory	

ASME B16.5 Class 300 Flanged												
Size (NPS)	Size (DN)	Dimensions				Available Construction			Weight			
		B		C		FAB with CS Flanges (Fixed or Rotating)	ATL	lbs.	kg			
		Inch	mm	Inch	mm							
1	25	2 1/4	57	2	51	•	•	7	3.2			
1 1/2	40	2 3/4	70	2 7/8	73	•	•	9.5	4.3			
2	50	3	76	3 5/8	92	•	•	13.5	6.1			
3	80	3 1/2	89	5	127	•	•	28	12.7			
4	100	4 1/2	114.3	6 3/16	157	•	•	53	24.1			
6	150	5 1/2	140	8 1/2	216	•	•	94	42.7			
8	200	6	152	10 5/8	270	•	•	143	65.0			