

1" Branch Instrument Tees, PP / PVDF / PFA-Lined

Vacuum Ratings:

1" - 8" PVDF-lined fittings are rated for full vacuum at 275°F.

1" - 12" Polypropylene-lined fittings with Cast DI or Cast Steel construction are rated for full vacuum at 225°F.

Consult factory for vacuum ratings on 14" and larger Polypropylene-lined fittings

Consult factory for vacuum ratings on PFA-lined fittings.

Note: Fittings shown as Cast DI or Cast Steel have fixed flanges

PP/PVDF-lined available in stainless steel

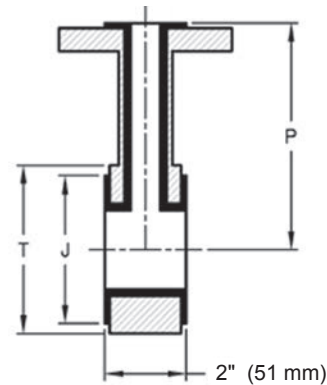

ASME B16.5 Class 150 Flanged												
Size (NPS)	Size (DN)	Dimensions						PP Cast Steel A216 WCB	PVDF Cast Steel A216 WCB	PFA Cast Steel A216 WCB	Weight	
		P		J		T					lbs.	kg
		Inch	mm	Inch	mm	Inch	mm					
1 x 1	25 x 25	3 1/2	89	2	51	2 5/8	67	●	●	●	5	2.3
1 1/2 x 1	40 x 25	4	102	2 7/8	73	3 3/8	86	●	●	●	7	3.2
2 x 1	50 x 25	4 1/2	114	3 5/8	92	4 1/8	105	●	●	●	9	4.1
3 x 1	80 x 25	5 1/2	140	5	127	5 3/8	137	●	●	●	11	5
4 x 1	100 x 25	6 1/2	165	6 3/16	157	6 3/4	171	●	●	●	17	7.7
6 x 1	150 x 25	8	203	8 1/2	216	8 3/4	222	●	●	●	21	9.5
8 x 1	200 x 25	9	229	10 5/8	270	11	279	●	●	●	29	13.2
10 x 1	250 x 25	11	279	12 3/4	324	13 3/8	340	●			69	31.4
12 x 1	300 x 25	12	305	15	381	16 1/8	410	●			77	35

ASME B16.5 Class 300 Flanged												
Size (NPS)	Size (DN)	Dimensions						PP Cast Steel A216 WCB	PVDF Cast Steel A216 WCB	PFA Cast Steel A216 WCB	Weight	
		P		J		T					lbs.	kg
		Inch	mm	Inch	mm	Inch	mm					
1 x 1	25 x 25	4	102	2	51	2 7/8	73	●	●	●	6	2.7
1 1/2 x 1	40 x 25	4 1/2	114	2 7/8	73	3 3/4	95	●	●	●	8	3.6
2 x 1	50 x 25	5	127	3 5/8	92	4 3/8	111	●	●	●	11	5
3 x 1	80 x 25	6	152	5	127	5 7/8	149	●	●	●	13	5.9
4 x 1	100 x 25	7	178	6 3/16	157	7 1/8	181	●	●	●	19	8.6
6 x 1	150 x 25	8 1/2	216	8 1/2	216	9 7/8	251	●	●	●	23	10.5

PP-lined fittings larger than 12" are available as rotationally-lined in standard and custom configurations up to NPS 24 (DN 600).

1 1/2" Branch Instrument Tees, PP / PVDF-Lined

Vacuum Ratings:

1" - 8" PVDF-lined fittings are rated for full vacuum at 275°F.

1" - 12" Polypropylene-lined fittings with Cast DI or Cast Steel construction are rated for full vacuum at 225°F.

Consult factory for vacuum ratings on 14" and larger Polypropylene-lined fittings

Consult factory for vacuum ratings on PFA-lined fittings.

Note: Fittings shown as Cast DI or Cast Steel have fixed flanges

PP/PVDF-lined available in stainless steel

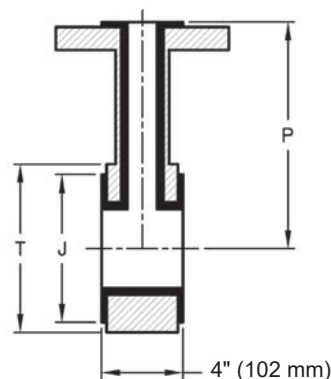

ASME B16.5 Class 150 Flanged												
Size (NPS)	Size (DN)	Dimensions						PP	PVDF	PFA	Weight	
		P		J		T		Cast Steel A216 WCB	Cast Steel A216 WCB	Cast Steel A216 WCB	lbs.	kg
		Inch	mm	Inch	mm	Inch	mm					
1 1/2 x 1 1/2	40 x 40	4	102	2 7/8	73	3 3/8	86	●	●	●	13	5.9
2 x 1 1/2	50 x 40	4 1/2	114	3 5/8	92	4 1/8	105	●	●	●	16	7.3
3 x 1 1/2	80 x 40	5 1/2	140	5	127	5 3/8	137	●	●	●	22	10
4 x 1 1/2	100 x 40	6 1/2	165	6 3/16	157	6 3/4	171	●	●	●	31	14.1
6 x 1 1/2	150 x 40	8	203	8 1/2	216	8 3/4	222	●	●	●	41	18.6
8 x 1 1/2	200 x 40	9	229	10 5/8	270	11	279	●	●	●	60	27.3
10 x 1 1/2	250 x 40	11	279	12 3/4	324	13 3/8	340	●			77	35
12 x 1 1/2	300 x 40	12	305	15	381	16 1/8	410	●			104	47.3
14 x 1 1/2	350 x 40	15 3/8	390	18 1/2	470	19 7/8	505	●			Consult Factory	
16 x 1 1/2	400 x 40	17 3/4	450	21	534	21 1/4	540	Fabricated Steel				

PP-lined fittings larger than 12" are available as rotationally-lined in standard and custom configurations up to NPS 24 (DN 600).

2" Branch Instrument Tees, PP / PVDF-Lined

Vacuum Ratings:

1" - 8" PVDF-lined fittings are rated for full vacuum at 275°F.

1" - 12" Polypropylene-lined fittings with Cast DI or Cast Steel construction are rated for full vacuum at 225°F.

Consult factory for vacuum ratings on 14" and larger Polypropylene-lined fittings

Consult factory for vacuum ratings on PFA-lined fittings.

Note: Fittings shown as Cast DI or Cast Steel have fixed flanges

PP/PVDF-lined available in stainless steel

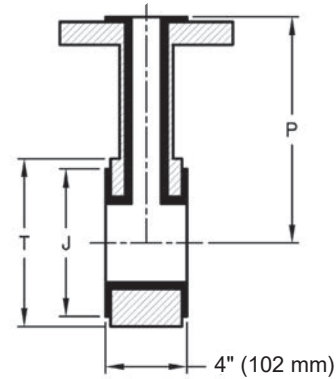

ASME B16.5 Class 150 Flanged												
Size (NPS)	Size (DN)	Dimensions						PP	PVDF	PFA	Weight	
		P		J		T		Cast Steel A216 WCB	Cast Steel A216 WCB	Cast Steel A216 WCB		
		Inch	mm	Inch	mm	Inch	mm				lbs.	kg
2 x 2	50 x 50	4 1/2	114	3 5/8	92	4 1/8	105	●	●	●	18	8.2
3 x 2	80 x 50	5 1/2	140	5	127	5 3/8	137	●	●	●	24	10.9
4 x 2	100 x 50	6 1/2	165	6 3/16	157	6 3/4	171	●	●	●	33	15
6 x 2	150 x 50	8	203	8 1/2	216	8 3/4	222	●	●	●	43	19.5
8 x 2	200 x 50	9	229	10 5/8	270	11	279	●	●	●	62	28.2
10 x 2	250 x 50	11	279	12 3/4	324	13 3/8	340	●		●	79	35.9
12 x 2	300 x 50	12	305	15	381	16 1/8	410	●			108	49.1
14 x 2	350 x 50	15 3/8	390	18 1/2	470	19 7/8	505	●			Consult Factory	
16 x 2	400 x 50	17 3/4	450	21	534	21 1/4	540	Fabricated Steel				

PP-lined fittings larger than 12" are available as rotationally-lined in standard and custom configurations up to NPS 24 (DN 600).