

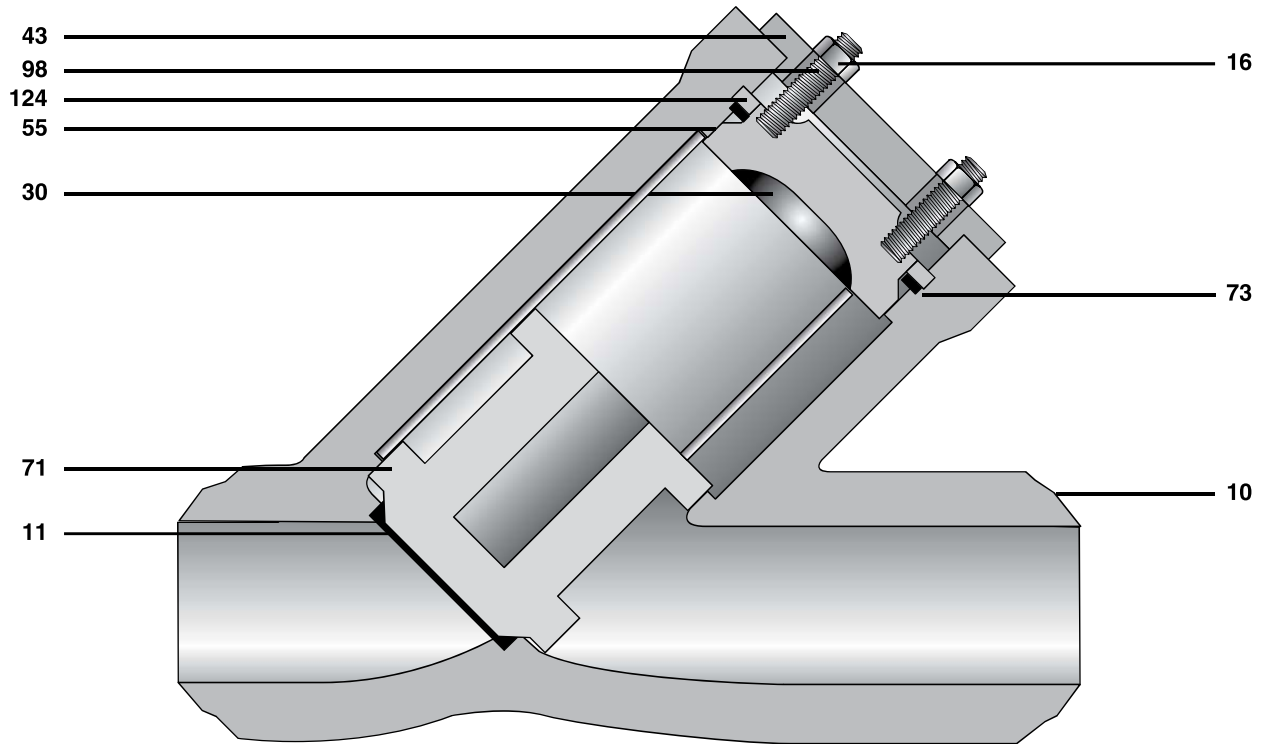

Materials Y-Lift Check Valves

Y-Lift-Check Valve



NO	PART NAME	CARBON STEEL	1¼ CHROME	2¼ CHROME	9Cr-1Mo-V	316 STAINLESS
10	BODY	ASTM A216 GR WCB OR WCC ¹ W/CO-CR	ASTM A217 GR WC6 W/CO-CR	ASTM A217 GR WC9 W/CO-CR	ASTM A217 GR C12A W/CO-CR	ASTM A351 GR CF8M W/CO-CR
11	SEAT RINGS	CARBON STEEL W/ CO-CR OVERLAY	316L SS OR 2¼ CR W/ CO-CR OVERLAY	316L SS OR 2¼ CR W/ CO-CR OVERLAY	ALLOY 91 W/ CO-CR OVERLAY	316L SS W/ CO-CR OVERLAY
16	STUD NUTS	ASTM A194 GR 2H	ASTM A194 GR 2H	ASTM A194 GR 2H	ASTM A194 GR 2H	ASTM A194 GR 2H
19	SCREW	A193 GR B7	A193 GR B7	A193 GR B7	A193 GR B7	A193 GR B7
30	BONNET CAP	CARBON STEEL	ASTM A182 GR F11/F22	ASTM A182 GR F22 W/	ASTM A182 GR F91 W/	ASTM A182 GR F316 W/
43	BONNET CARRIER	CARBON STEEL	CARBON STEEL	CARBON STEEL	CARBON STEEL	CARBON STEEL
55	GASKET	GRAPHITE/SS CAPS OR MILD STEEL SILVER PLATED*	GRAPHITE/SS CAPS OR MILD STEEL SILVER PLATED*	GRAPHITE/SS CAPS OR MILD STEEL SILVER PLATED*	GRAPHITE/SS CAPS OR MILD STEEL SILVER PLATED*	GRAPHITE/SS CAPS OR MILD STEEL SILVER PLATED*
71	DISC	CARBON STEEL W/CO-CR	316L SS OR 2¼ CR W/CO-CR	316L SS OR 2¼ CR W/CO-CR	316L SS W/CO-CR	316L SS W/CO-CR
73	THRUST RING ²	AISI 4140/4340	AISI 4140/4340	AISI 4140/4340	AISI 4140/4340	AISI 4140/4340
98	BONNET STUDS	ASTM A193 GR B7	ASTM A193 GR B7	ASTM A193 GR B7	ASTM A193 GR B7	ASTM A193 GR B7
98a	BOLT	ASTM A193 GR B7	ASTM A193 GR B7	ASTM A193 GR B7	ASTM A193 GR B7	ASTM A193 GR B7
124	SEGMENT RING	AISI 4140 OR 4340	AISI 4140 OR 4340	AISI 4140 OR 4340	AISI 4140 OR 4340	AISI 4140 OR 4340

Pacific Valves® reserves the right to change or modify product design or construction without prior notice and without incurring any obligation to make such changes and modifications on products previously or subsequently sold.

NOTES:

1. WCC valve bonnets and internals will be manufactured with 300 series SS and/or 2¼ CR.
2. Thrust ring comes standard on 12" and larger ASME class 1500 and all sizes of ASME class 2500.

*Graphite Pressure Seal Bonnet Gasket standard. Mild Steel Silver Plated available on request.



Dimensions Y-Lift-Check Valves • ASME Class 600

Y-Lift-Check Valves

Fig. No. 59606-7-WE* Butt Weld Ends

Dim	Description		VALVE SIZES (inches)								
			6	8	10	12	14	16	18	20	24
A	End-to-End Weld Ends	in	18.00	23.00	28.00	32.00	32.00	41.00	41.00	60.00	66.00
		mm	457	584	711	813	813	1041	1041	1524	1676
K	Center-to-Top	in	16.00	20.00	25.00	32.38	32.38	41.50	41.50	47.00	55.75
		mm	406	508	635	822	822	1054	1054	1194	1416
	Weight Weld Ends	lbs	400	600	1000	1450	1450	2800	2800	3500	5000
		kg	182	272	454	658	658	1270	1270	1588	2269

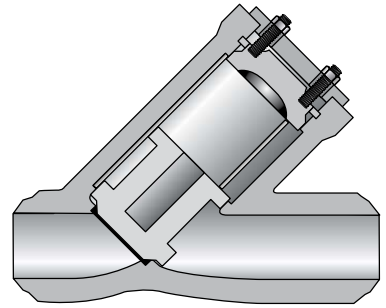

VENTURI Y-LIFT-CHECK VALVE

Y-Lift-Check Valve Fig No. 59606-7-WE* Butt Weld Ends

Dim	Description		VALVE SIZES (inches)								
			8x6x8	10x8x10	12x10x12	14x12x14	16x14x16	18x16x18	20x18x20	22x20x22	26x24x26
A	End-to-End Weld Ends	in.	18.00	23.00	28.00	32.00	32.00	41.00	41.00	60.00	66.00
		mm	457	584	711	813	813	1041	1041	1524	1676
K	Center-to-Top	in.	16.00	20.00	25.00	32.38	32.38	41.50	41.50	47.00	55.75
		mm	406	508	635	822	822	1054	1054	1194	1416
	Weight Weld Ends	lbs	400	668	1115	1595	1595	3080	3080	3900	5550
		kg	182	303	506	724	724	1397	1397	1770	2518

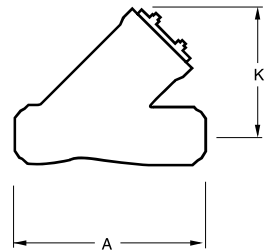

General Notes:

- Dimensions, weights, and other engineering data are subject to change or modification. This data is not to be used for construction unless confirmed by Pacific Valves®.
- For best performance, size for full open operation. See Flow Calculations in the Technical Data Section.
* Specify pipe schedule.
- Related data available in Technical Data, Actuators, and Accessories sections.



Dimensions Y-Lift Check Valves • ASME Class 900

Y-Lift-Check Valves

Fig. No. 59609-7-WE* Butt Weld Ends

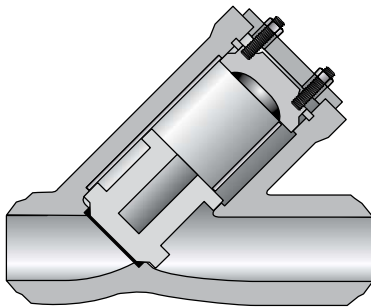

Dim	Description		VALVE SIZES (inches)								
			6	8	10	12	14	16	18	20	24
A	End-to-End Weld Ends	in	27.75	30.00	36.25	41.00	43.00	54.00	63.00	54.50	59.50
		mm	705	762	921	1041	1092	1372	1600	1384	1511
K	Center-to-Top	in	18.7	23.53	28.20	35.10	35.10	44.43	44.43	52.44	62.81
		mm	475	598	716	891	891	1129	1129	1332	1595
	Weight Weld Ends	lbs	400	624	1160	1580	1580	3080	3130	3920	5860
		kg	182	284	527	718	718	1397	1420	1782	2664

VENTURI Y-LIFT-CHECK VALVE

Y-Lift-Check Valve Fig No. 59609-7-WE* Butt Weld Ends

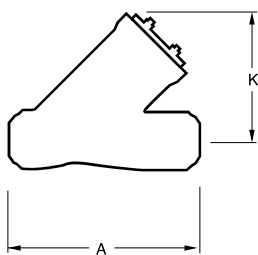

Dim	Description		VALVE SIZES (inches)								
			8x6x8	10x8x10	12x10x12	14x12x14	16x14x16	18x16x18	20x18x20	22x20x22	26x24x26
A	End-to-End Weld Ends	in.	27.75	30.00	36.25	41.00	43.00	54.00	63.00	54.50	59.50
		mm	705	762	921	1041	1092	1372	1600	1384	1511
K	Center-to-Top	in.	18.7	23.53	28.20	35.10	35.10	44.43	44.43	52.44	62.81
		mm	475	598	716	891	891	1129	1129	1332	1595
	Weight Weld Ends	lbs	400	695	1280	1750	1750	3380	3440	4350	6510
		kg	182	316	582	795	794	1534	1560	1977	2959

General Notes:

- Dimensions, weights, and other engineering data are subject to change or modification. This data is not to be used for construction unless confirmed by Pacific Valves®.
- For best performance, size for full open operation. See Flow Calculations in the Technical Data Section.
* Specify pipe schedule.
- Related data available in Technical Data, Actuators, and Accessories sections.



Dimensions Y-Lift-Check Valves • ASME Class 1500

Y-Pattern Globe Lift-Check Valves

Fig. No. 59615-7-WE Butt Weld Ends

Dim	Description		VALVE SIZES (inches)								
			6	8	10	12	14	16	18	20	24
A	End-to-End Weld Ends	in	27.75	30.00	36.25	41.00	43.00	54.00	63.00	54.50	59.50
		mm	705	762	921	1041	1092	1372	1600	1384	1511
K	Center-to-Top	in	18.7	23.53	28.20	35.10	35.10	44.43	44.43	52.44	62.81
		mm	475	598	716	891	891	1129	1129	1332	1595
	Weight Weld Ends	lbs	400	624	1160	1580	1580	3080	3130	3920	5860
		kg	182	284	527	718	718	1397	1420	1782	2664

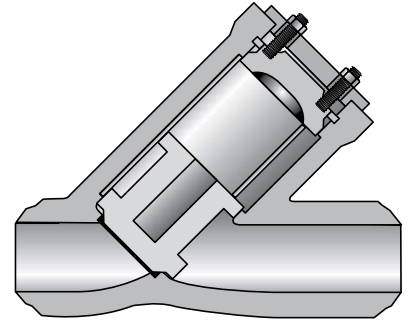

VENTURI Y-LIFT-CHECK VALVE

Y-Lift-Check Valve Fig No. 59615-7-WE* Butt Weld Ends

Dim	Description		VALVE SIZES (inches)								
			8x6x8	10x8x10	12x10x12	14x12x14	16x14x16	18x16x18	20x18x20	22x20x22	26x24x26
A	End-to-End Weld Ends	in.	27.75	30.00	36.25	41.00	43.00	54.00	63.00	54.50	59.50
		mm	705	762	921	1041	1092	1372	1600	1384	1511
K	Center-to-Top	in.	18.7	23.53	28.20	35.10	35.10	44.43	44.43	52.44	62.81
		mm	475	598	716	891	891	1129	1129	1332	1595
	Weight Weld Ends	lbs	400	695	1280	1750	1750	3380	3440	4350	6510
		kg	182	316	582	795	794	1534	1560	1977	2959

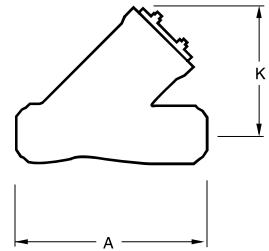

General Notes:

- Dimensions, weights, and other engineering data are subject to change or modification. This data is not to be used for construction unless confirmed by Pacific Valves®.
- For best performance, size for full open operation. See Flow Calculations in the Technical Data Section.
* Specify pipe schedule.
- Related data available in Technical Data, Actuators, and Accessories sections.



Dimensions Y-Lift Check Valves • ASME Class 2500

Y-Lift-Check Valves

Fig. No. 59625H-7-WE* Butt Weld Ends

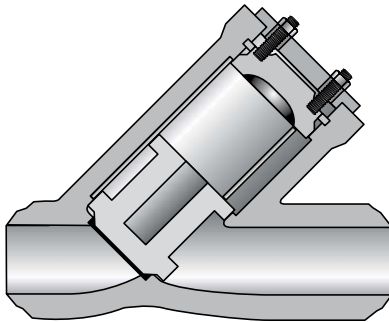

Dim	Description		VALVE SIZES (inches)								
			6	8	10	12	14	16	18	20	24
A	End-to-End Weld Ends	in.	30.00	30.00	36.00	41.00	48.75	48.75	58.00	58.00	68.00
		mm	762	762	914	1041	1238	1238	1473	1473	1727
K	Center-to-Top	in.	24.11	24.11	29.95	34.60	37.33	37.33	47.44	47.44	50.56
		mm.	612	612	761	879	948	95	1205	1205	1284
	Weight Weld Ends	lbs	660	660	1180	1898	3040	3040	4750	4650	7000
		kg	300	300	585	863	1380	1380	2159	2159	3176

VENTURI Y-LIFT-CHECK VALVE

Y-Lift-Check Valve Fig. No. 59625H-7-WE* Butt Weld Ends

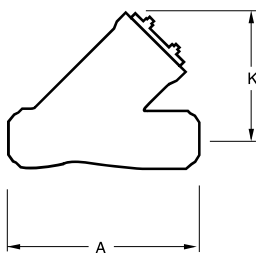

Dim	Description		VALVE SIZES (inches)								
			8x6x8	10x8x10	12x10x12	14x12x14	16x14x16	18x16x18	20x18x20	22x20x22	26x24x26
A	End-to-End Weld Ends	in.	30.00	30.00	36.00	41.00	48.75	48.75	58.00	58.00	68.00
		mm	762	762	914	1041	1238	1238	1473	1473	1727
K	Center-to-Top	in.	24.11	24.11	29.95	34.60	37.33	37.33	47.44	47.44	50.56
		mm	612	612	761	879	948	95	1205	1205	1284
	Weight Weld Ends	lbs	725	725	1310	2110	3375	3375	5275	5272	7770
		kg	329	329	594	959	1530	1530	2398	2392	3525

General Notes:

1. Dimensions, weights, and other engineering data are subject to change or modification. This data is not to be used for construction unless confirmed by Pacific Valves®.
2. For best performance, size for full open operation. See Flow Calculations in the Technical Data Section.
* Specify pipe schedule.
3. Related data available in Technical Data, Actuators, and Accessories sections.