

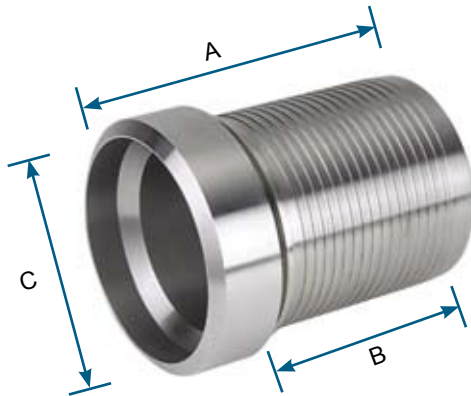

# Specialty Fittings



Butt Weld  
Style # 99

Butt Weld Tube / Pipe Fitting				
Size	A	B	C Tube	C Pipe
1/2"	2.740	1.618	0.500	0.840
3/4"	3.000	1.618	0.725	1.050
1"	3.160	1.718	1.000	1.312
1-1/2"	3.500	1.967	1.500	1.900
2"	4.000	2.250	2.000	2.375
3"	4.588	3.400	3.000	3.500
4"	4.813	3.625	4.000	4.500

## Butt Weld Fittings

- Schedule 5, 10, and 40 pipe
- Sanitary O.D. tube
- Extra-long lengths available

### Commonly Selected Material

316 Stainless Steel

Consult factory for other materials

Note: Buttweld fittings are available for purchase as bulk fittings, only, and are not available on factory-made assemblies.

Note: These fittings can be factory customized by welding virtually any end configuration needed.